

System (CPS)

GageWoven can be specified as sheet goods for fabrication by the installing contractor. GageWoven also offers the advantage of factory pre-fabricated panels and other installer friendly systems to provide cost effective and flexible solutions for the specifier, contractor, as well as the end user. Our engineering department can also work with the specifier or contractor to develop a mounting system to meet the specific needs of the project.

The **concealed panel system** (referred to as CPS) is available directly from the factory as a ready to install panel. The wire mesh is secured to the backer panel using a concealed attachment method, either using welded studs or other attachment techniques. Not all of our 23 standard patterns are suitable for this system. This system is often used for elevator cab interiors, elevator lobbies, and feature walls. Several options are available (see below) based on the mesh that is selected. Opaque designs do not require a background material; however, open mesh designs are standard with either a black laminate or brushed aluminum field. The designer can further enhance the panel by specifying a custom laminate or other material for the field.

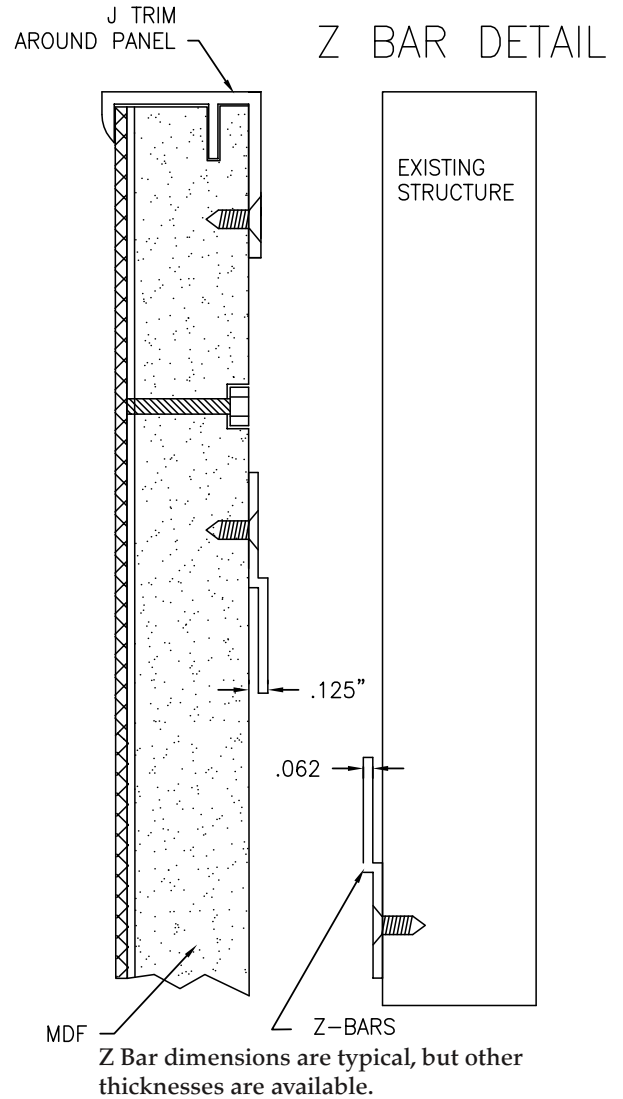

System Version 1

Opaque woven wire mesh attached to MDF (Medium Density Fiberboard) substrate or alternative.

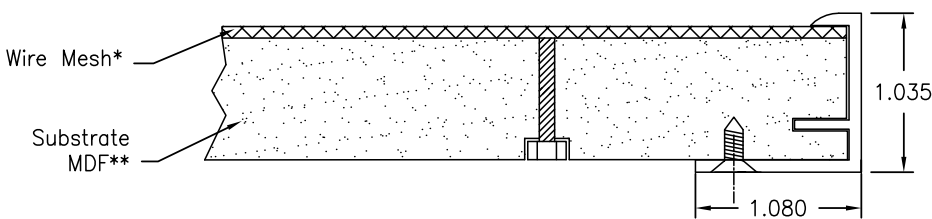

System Version 2

First layer open woven wire mesh, second layer key color depending on customer specification with MDF substrate.

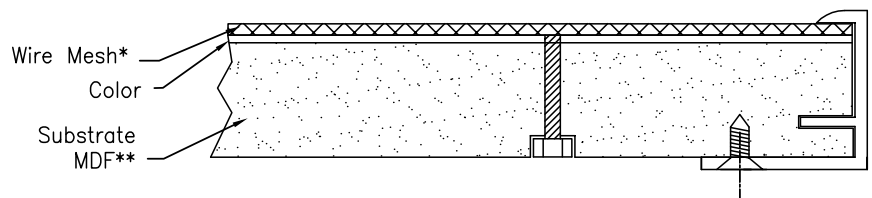

NOTE

- * Thickness of wire mesh is dependent on pattern and material.
- ** MDF thickness will be adjusted according to the thickness of the wire mesh.
Fire rated MDF available.
Number of studs and screws will depend on mesh and substrates.
All versions attached with J molding extrusion. Panels attached to wall with Z bars.